



PUMPS {POUCHED PRODUCTS} EXPRESS™ CENTER

Models EC
EC-TWIN

Date:

Project:

Quantity:

Item Number:



EC 07130



EC-TWIN 07120



THIN THICK PARTICULATE
See category tab for details.



Warranty

Server Products equipment is backed by a two-year limited warranty against defects in materials and workmanship. For a copy of our complete warranty statement, see our web site or contact us.

Bid Description

The Express Center™ is constructed of a brushed finish stainless steel base. The front section is furnished with a Server Express™ System—a surgical-quality plastic, condiment pump in a black thermoset polyester vessel. Pump vessel lid is polished stainless steel. The back section includes a Serve-A-Cup™ soufflé cup dispenser which is constructed of a polypropylene cup tube.

The Express™ System capacity is 1½ gallons (or 6 L). Maximum stroke yields 1 ounce (30 mL). Portion control reduces the yield in ¼ ounce (7 mL) increments. NSF listed unit exclusively uses a Cryovac® pouch with 16 mm fitment.

The Serve-A-Cup™ includes cup guides and strippers to dispense ¾ and 1 ounce (22, 30 mL) paper or plastic soufflé cups one-at-a-time. Capacity is approximately (100) paper cups.

The Twin Express Center consists of a brushed finish stainless steel base furnished with (2) Server Express™ Systems and (2) Serve-A-Cup™ soufflé cup dispensers, as described above.

Standard Features

Pump vessel holds a 1½ gallon (or 6 L) Cryovac® pouch

New Server pump is constructed of surgical-quality plastic parts — quick to breakdown and completely dishwasher safe

Pump is ADA compliant, at ½ oz and ¼ oz portions, requiring less than 5 lbs of pressure to dispense

Maximum stroke yields 1 ounce (30 mL)

Easy-to-adjust portion control in ¼ ounce (7 mL) increments

Discharge tube fitting — **new** design works with ketchup, mustard and mayonnaise

Express Center™ Accessories

- ☐ Duckbill Discharge Fitting 07454
- ☐ Replacement Pump 07537
- ☐ Decal Set: Ketchup, Mustard, Mayo 07131

Specifications on reverse side



PUMPS {POUCHED PRODUCTS} EXPRESS™ CENTER

Models EC
EC-TWIN

Express Center™ EC 07130

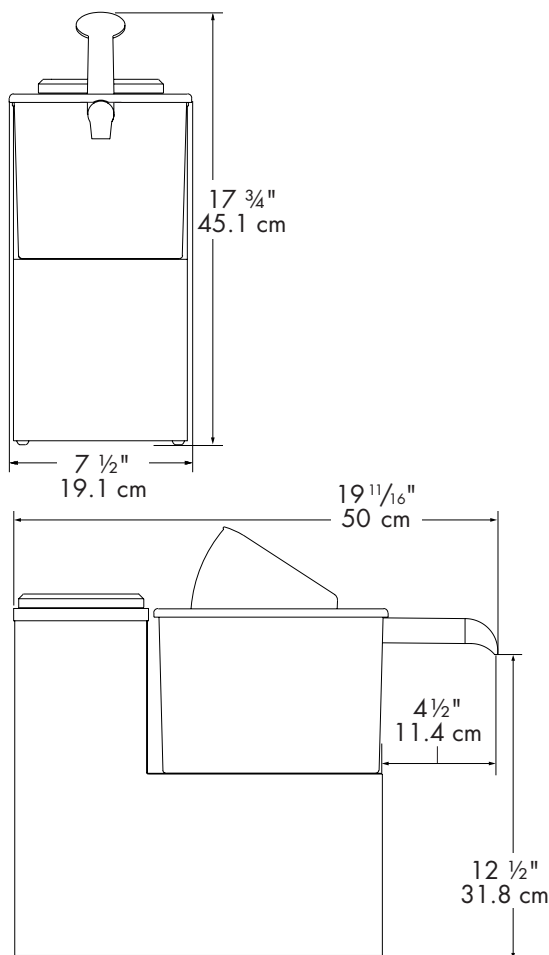

Express Center-Twin™ EC-TWIN 07120

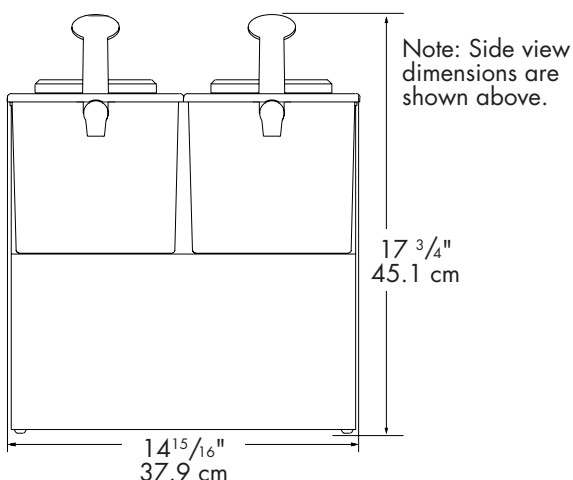

Specifications

Model	EC 07130			
Construction	Stainless steel base with brushed finish. Includes surgical-quality plastic pump, black thermoset polyester vessel and polypropylene (tube) soufflé cup dispenser. Pump vessel lid is stainless steel.			
Capacity	1 ½ gallon (or 6 L) capacity			
Dimensions		<u>Height</u>	<u>Width</u>	<u>Depth</u>
	in	17 ¾	7 ½	19 11/16
	cm	45.1	19.1	50
Ship Weight	16 lb (7.3 kg)			
Model	EC-TWIN 07120			
	Same as above except:			
Construction	Complete with two surgical-quality plastic pumps, black thermoset polyester vessels and polypropylene (tube) soufflé cup dispensers.			
Capacity	1 ½ gallon (or 6 L) capacity per pump vessel – 3 gallons (or 12 L) total			
Dimensions		<u>Height</u>	<u>Width</u>	<u>Depth</u>
	in	17 ¾	14 15/16	19 11/16
	cm	45.1	37.9	50
Weight	27 lb (12.4 kg)			

Cryovac® is a registered trademark and a trade name of Cryovac Inc.
FOB Richfield, Wisconsin 53076

CAD Library

Individual CAD images can be downloaded from product pages on our web site. We are also a member of The KCL CAdalog with more than 100 other manufacturers. Our complete collection of CAD files can be purchased through Kochman Consultants, Ltd. at kclcad.com.



Server Products, Inc. • P.O. Box 98 • Richfield, WI 53076 • Toll Free: 800-558-8722
P: 262-628-5600 • F: 262-628-5110 • spsales@server-products.com • server-products.com

Server Products, Inc. reserves the right to modify specifications without obligation. Printed in USA

9.2009/1M Stock 02062